

HORIZONTAL DATUM:
WASHINGTON STATE PLANE COORDINATE
SYSTEM, SOUTH ZONE, NAD 83/2011 (PER PORT
OF TACOMA SURVEY CONTROL MAP - 2016)

VERTICAL DATUM:
MLLW (PER PORT OF TACOMA 2016 SURVEY
CONTROL MAP)
TIDE 22 1935 BENCHMARK: LOCATED AT NE
CORNER OF 11TH STREET BRIDGE AT THE
INTERSECTION OF 11TH STREET AND
MILWAUKEE WAY
ELEVATION = +19.18
(BASED ON 1983-2001 TIDAL EPOCH)

SITE TEMPORARY BENCHMARK:
PORT OF TACOMA MONUMENT #104 AT
INTERSECTION OF PORT OF TACOMA ROAD
AND MAXWELL WAY
ELEVATION = +17.59

0.00 FT MLLW + 2.67 FT = 0.00 NAVD88

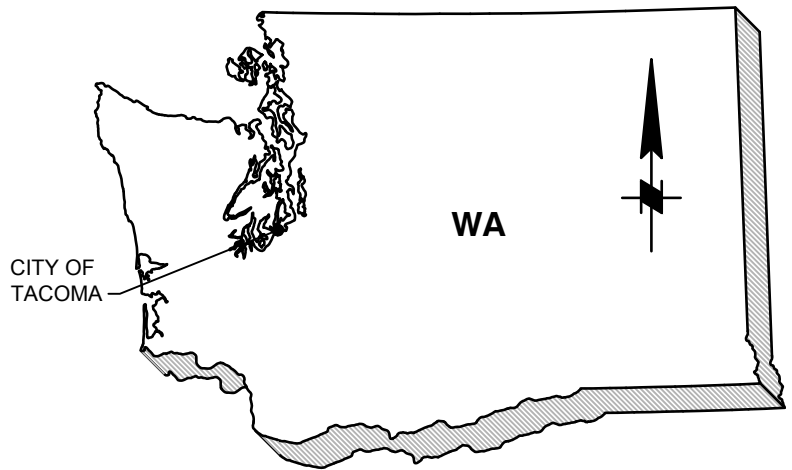

DIRECTIONS TO SITE FROM SEATTLE:

- | | <u>MILES</u> |
|------------------------------------|--------------|
| 1. I-5 S TO EXIT #136 | ~30 |
| 2. TURN RIGHT ON PORT OF TACOMA RD | ~0.5 |
| 3. ARRIVE AT PROJECT SITE | ~1.8 |

VICINITY MAP
SCALE: NTS

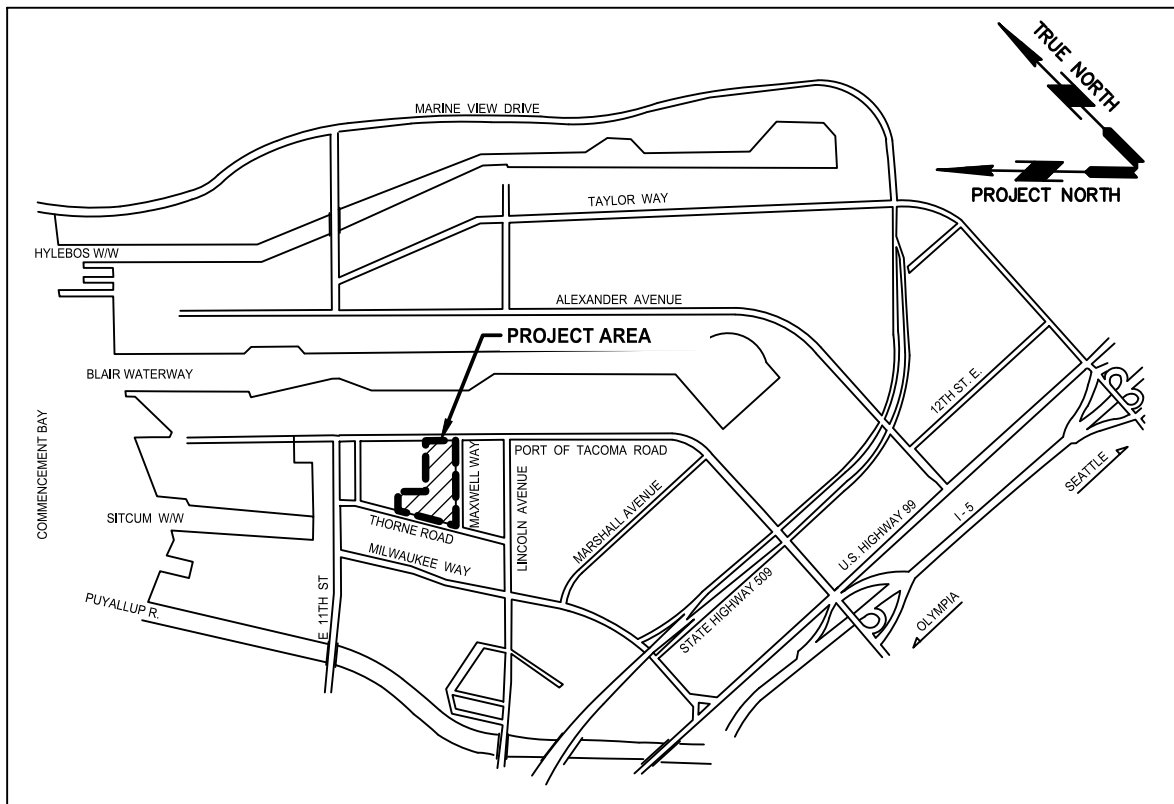

LOCATION MAP
SCALE: NTS

USACE REFERENCE: NWS-2020-557-WRD

APPLICANT: PORT OF TACOMA

ADJACENT PROPERTY OWNERS:
SEE THE JOINT AQUATIC RESOURCES
PERMIT APPLICATION (JARPA)

LOCATION: 1451 & 1721 THORNE ROAD AND
1702 PORT OF TACOMA ROAD
TACOMA, WA

LAT/LONG: 47.264 N
-122.401 W

DATUM: MLLW=19.39' TIDE 22 1935 BENCHMARK
SHEET: 1 OF 7 DATE: OCTOBER 22, 2022

PROPOSED PROJECT: OFF-DOCK CONTAINER
SUPPORT FACILITY

IN: NOT LOCATED IN A WATERBODY
NEAR/AT: CITY OF TACOMA
COUNTY: PIERCE STATE: WA
SEC: 34 T: 21 N R: 3 E

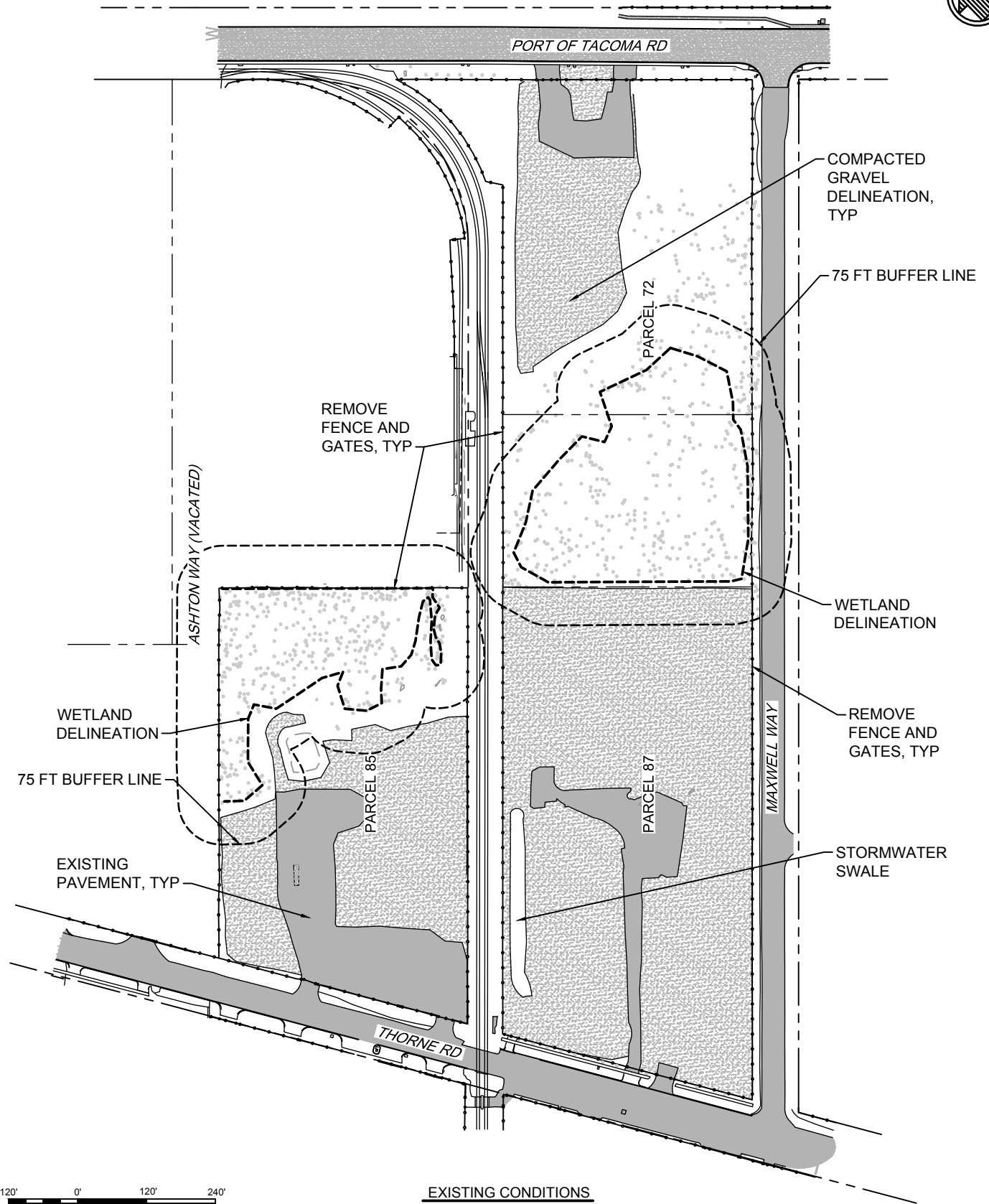

EXISTING CONDITIONS

SCALE: 1"=240'

USACE REFERENCE: NWS-2020-557-WRD

APPLICANT: PORT OF TACOMA

ADJACENT PROPERTY OWNERS:
SEE THE JOINT AQUATIC RESOURCES
PERMIT APPLICATION (JARPA)

LOCATION: 1451 & 1721 THORNE ROAD AND
1702 PORT OF TACOMA ROAD
TACOMA, WA

LAT/LONG: 47.264 N
-122.401 W

DATUM: MLLW=19.39' TIDE 22 1935 BENCHMARK
SHEET: 2 OF 7 **DATE:** OCTOBER 22, 2022

PROPOSED PROJECT: OFF-DOCK CONTAINER
SUPPORT FACILITY

IN: NOT LOCATED IN A WATERBODY
NEAR/AT: CITY OF TACOMA
COUNTY: PIERCE **STATE:** WA
SEC: 34 **T:** 21 N **R:** 3 E

File: Q:\SEA\10284-02\CADD\Active\JARPA\1028402_F2-F3

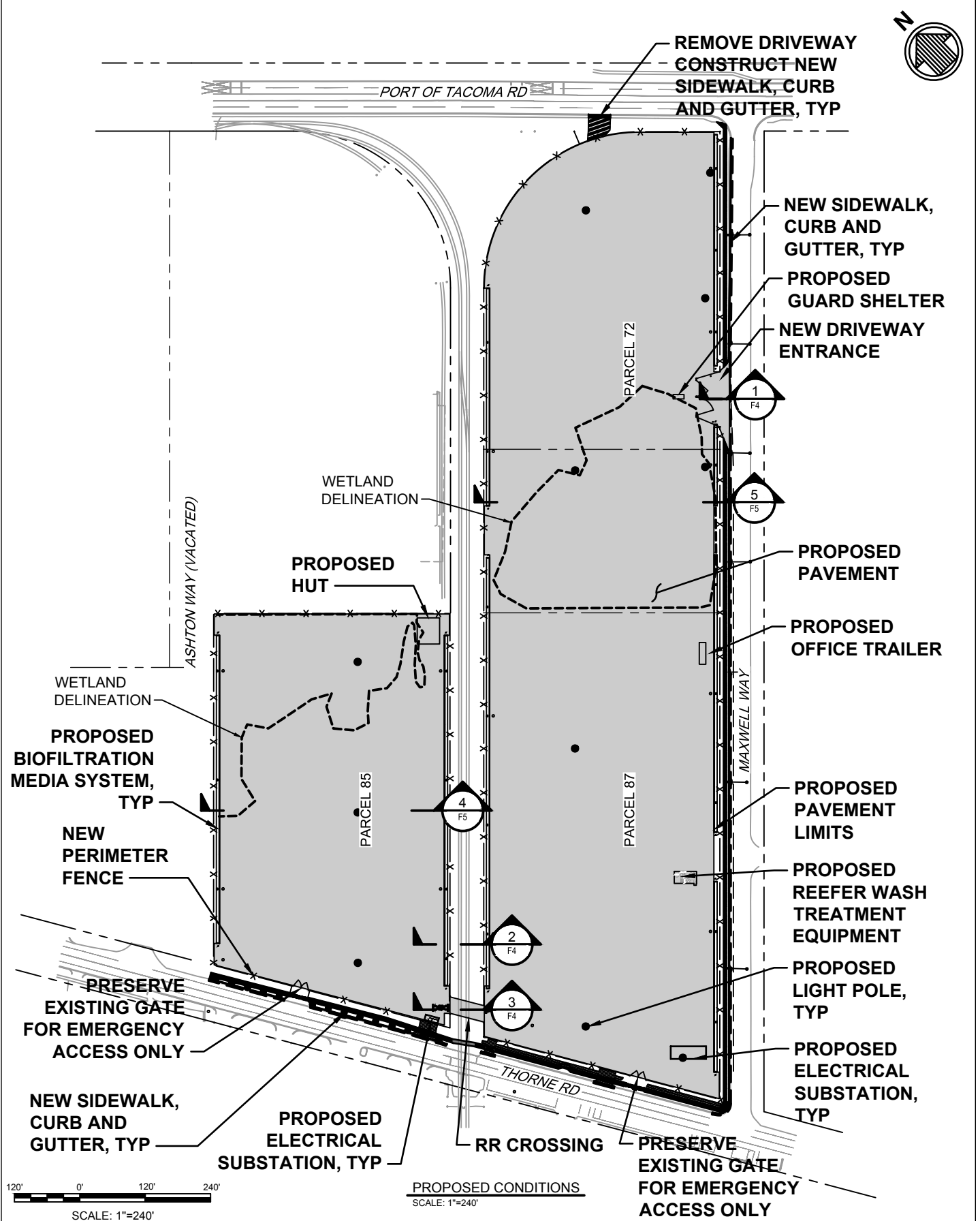

USACE REFERENCE: NWS-2020-557-WRD

APPLICANT: PORT OF TACOMA

ADJACENT PROPERTY OWNERS:
SEE THE JOINT AQUATIC RESOURCES
PERMIT APPLICATION (JARPA)

LOCATION: 1451 & 1721 THORNE ROAD AND
1702 PORT OF TACOMA ROAD
TACOMA, WA

LAT/LONG: 47.264 N
-122.401 W

DATUM: MLLW=19.39' TIDE 22 1935 BENCHMARK
SHEET: 3 OF 7 DATE: OCTOBER 22, 2022

PROPOSED PROJECT: OFF-DOCK CONTAINER
SUPPORT FACILITY

IN: NOT LOCATED IN A WATERBODY
NEAR/AT: CITY OF TACOMA
COUNTY: PIERCE STATE: WA
SEC: 34 T: 21 N R: 3 E

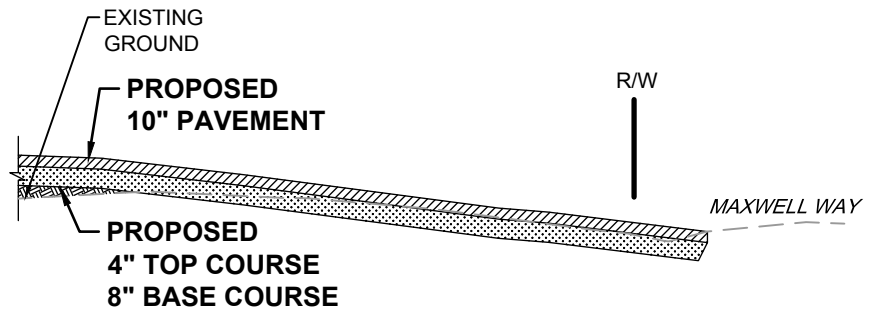

1 SECTION @ MAXWELL WAY ENTRANCE
F3 SCALE: 1"=40'

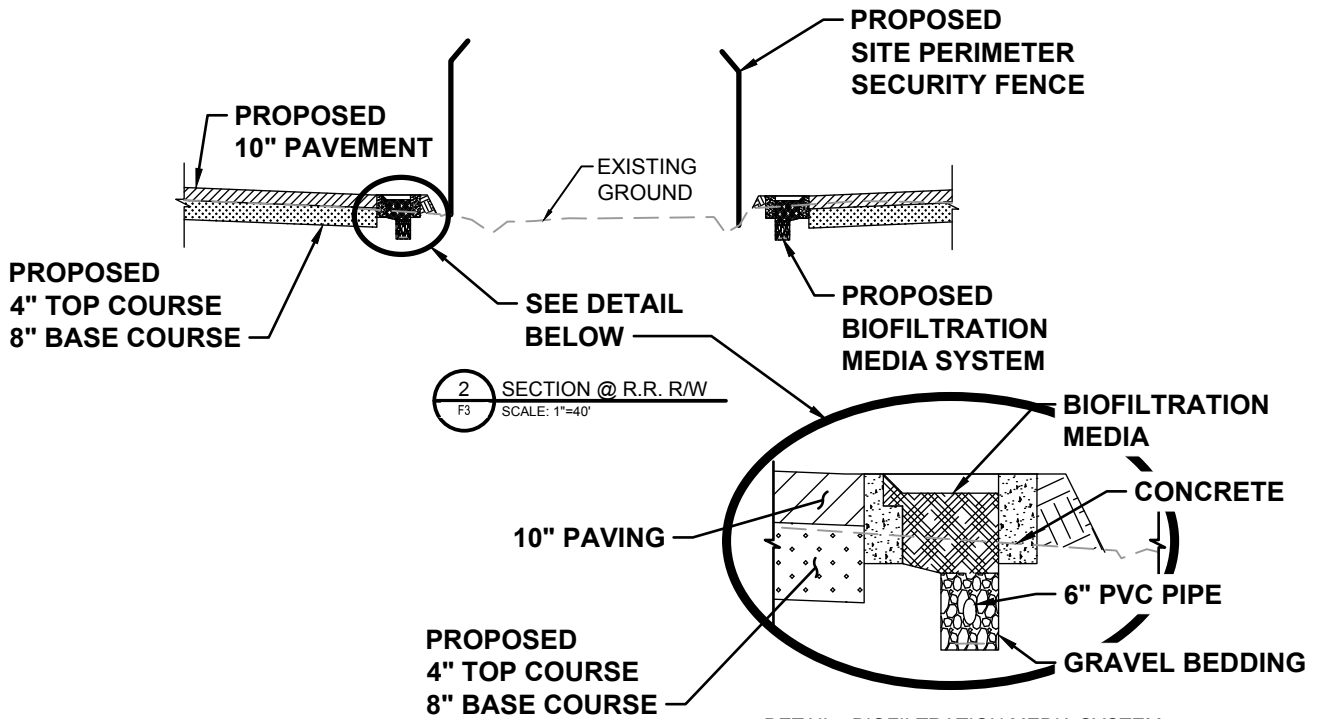

DETAIL - BIOFILTRATION MEDIA SYSTEM
SCALE: 1"=10'

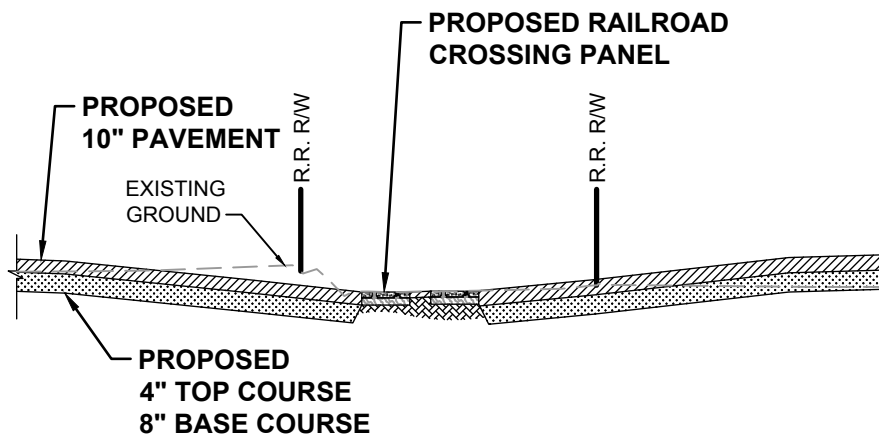

3 SECTION @ R.R. CROSSING PANELS
F3 SCALE: 1"=40'

40' 0' 40' 80'
SCALE: 1"=40'

USACE REFERENCE: NWS-2020-557-WRD

APPLICANT: PORT OF TACOMA

ADJACENT PROPERTY OWNERS:
SEE THE JOINT AQUATIC RESOURCES
PERMIT APPLICATION (JARPA)

LOCATION: 1451 & 1721 THORNE ROAD AND
1702 PORT OF TACOMA ROAD
TACOMA, WA
LAT/LONG: 47.264 N
-122.401 W
DATUM: MLLW=19.39' TIDE 22 1935 BENCHMARK
SHEET: 4 OF 7 DATE: OCTOBER 22, 2022

PROPOSED PROJECT: OFF-DOCK CONTAINER
SUPPORT FACILITY

IN: NOT LOCATED IN A WATERBODY
NEAR/AT: CITY OF TACOMA
COUNTY: PIERCE STATE: WA
SEC: 34 T: 21 N R: 3 E

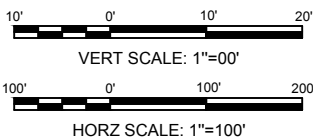
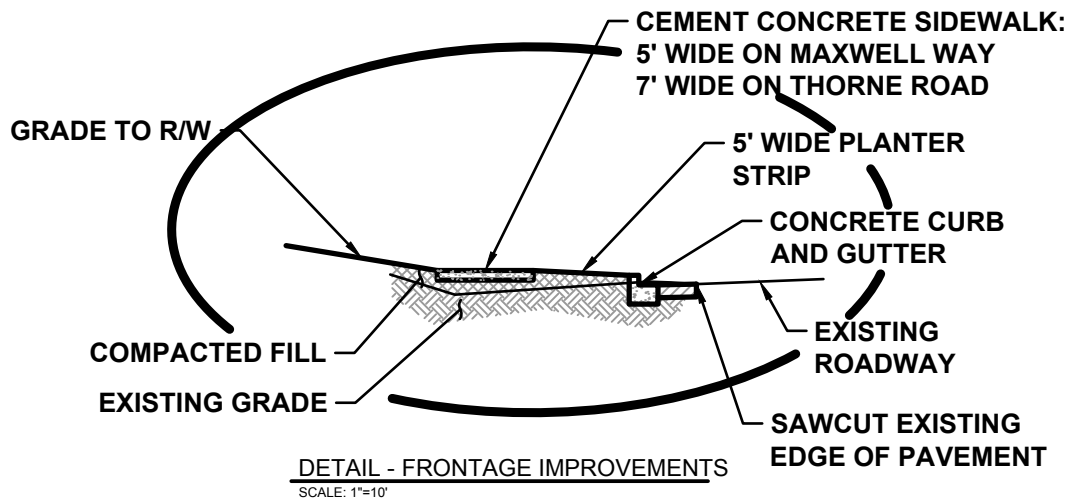
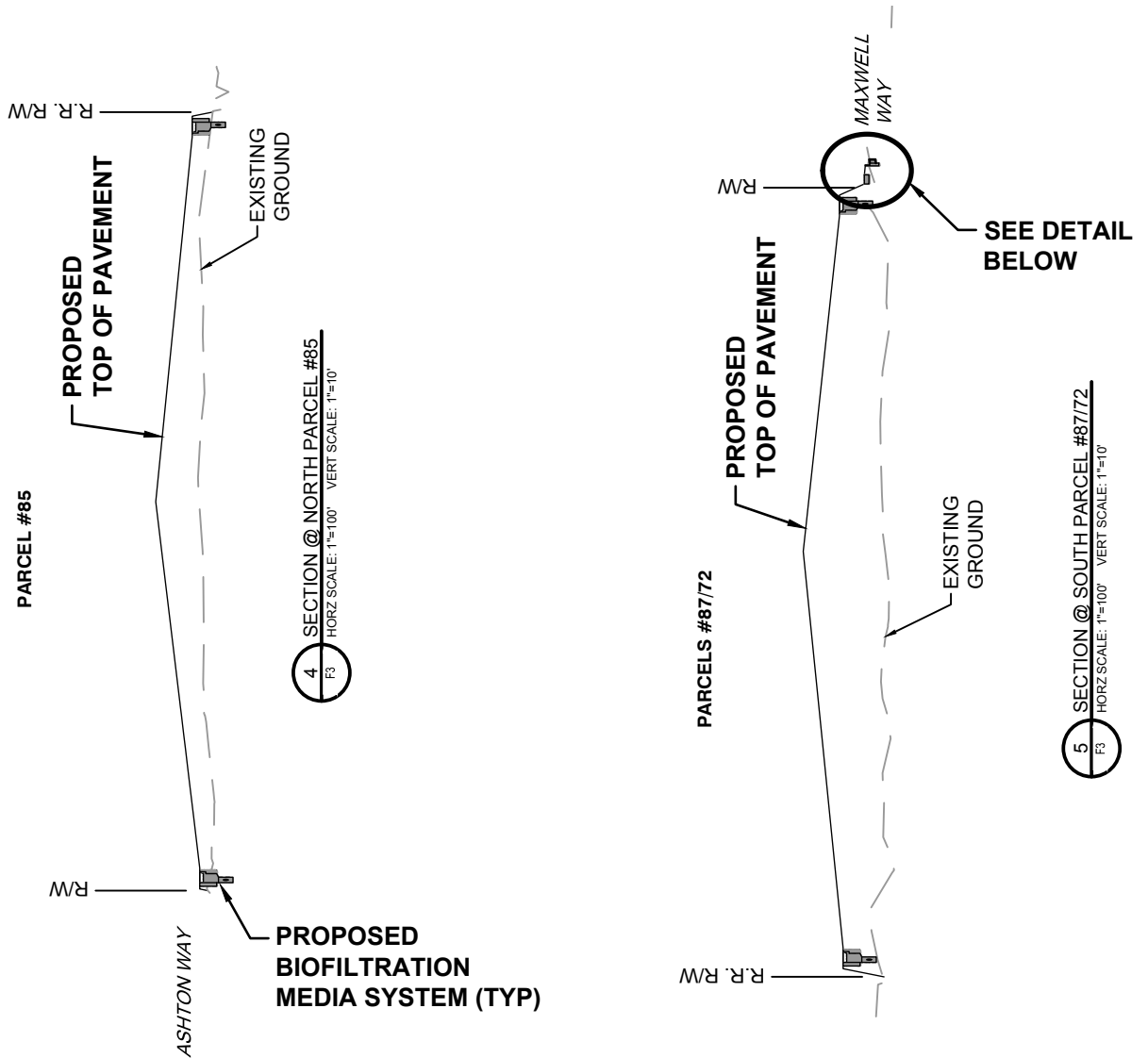

USACE REFERENCE: NWS-2020-557-WRD

APPLICANT: PORT OF TACOMA

ADJACENT PROPERTY OWNERS:
SEE THE JOINT AQUATIC RESOURCES
PERMIT APPLICATION (JARPA)

LOCATION: 1451 & 1721 THORNE ROAD AND
1702 PORT OF TACOMA ROAD
TACOMA, WA

LAT/LONG: 47.264 N
-122.401 W

DATUM: MLLW=19.39' TIDE 22 1935 BENCHMARK

SHEET: 5 OF 7 DATE: OCTOBER 22, 2022

PROPOSED PROJECT: OFF-DOCK CONTAINER
SUPPORT FACILITY

IN: NOT LOCATED IN A WATERBODY
NEAR/AT: CITY OF TACOMA
COUNTY: PIERCE STATE: WA
SEC: 34 T: 21 N R: 3 E

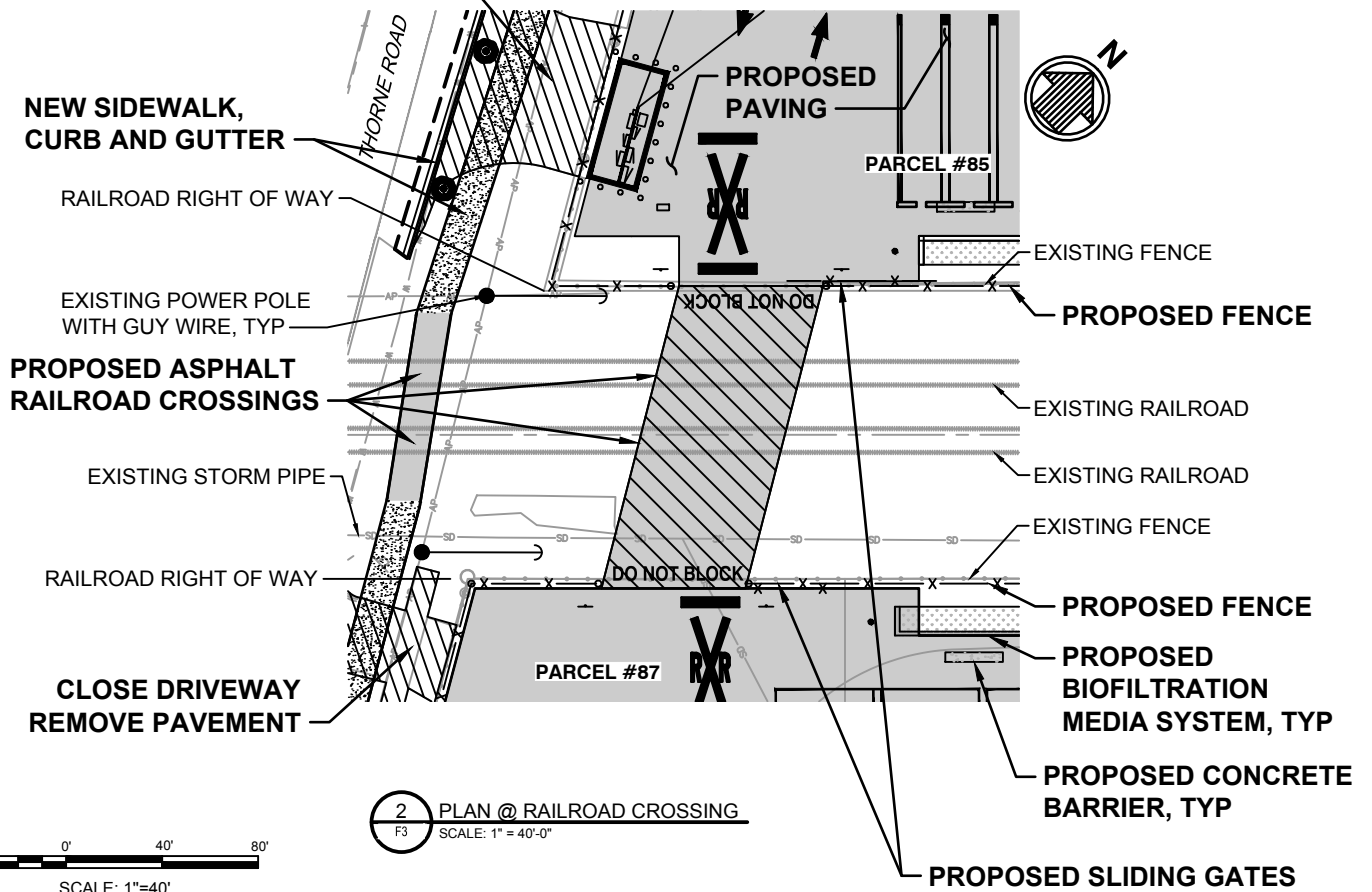
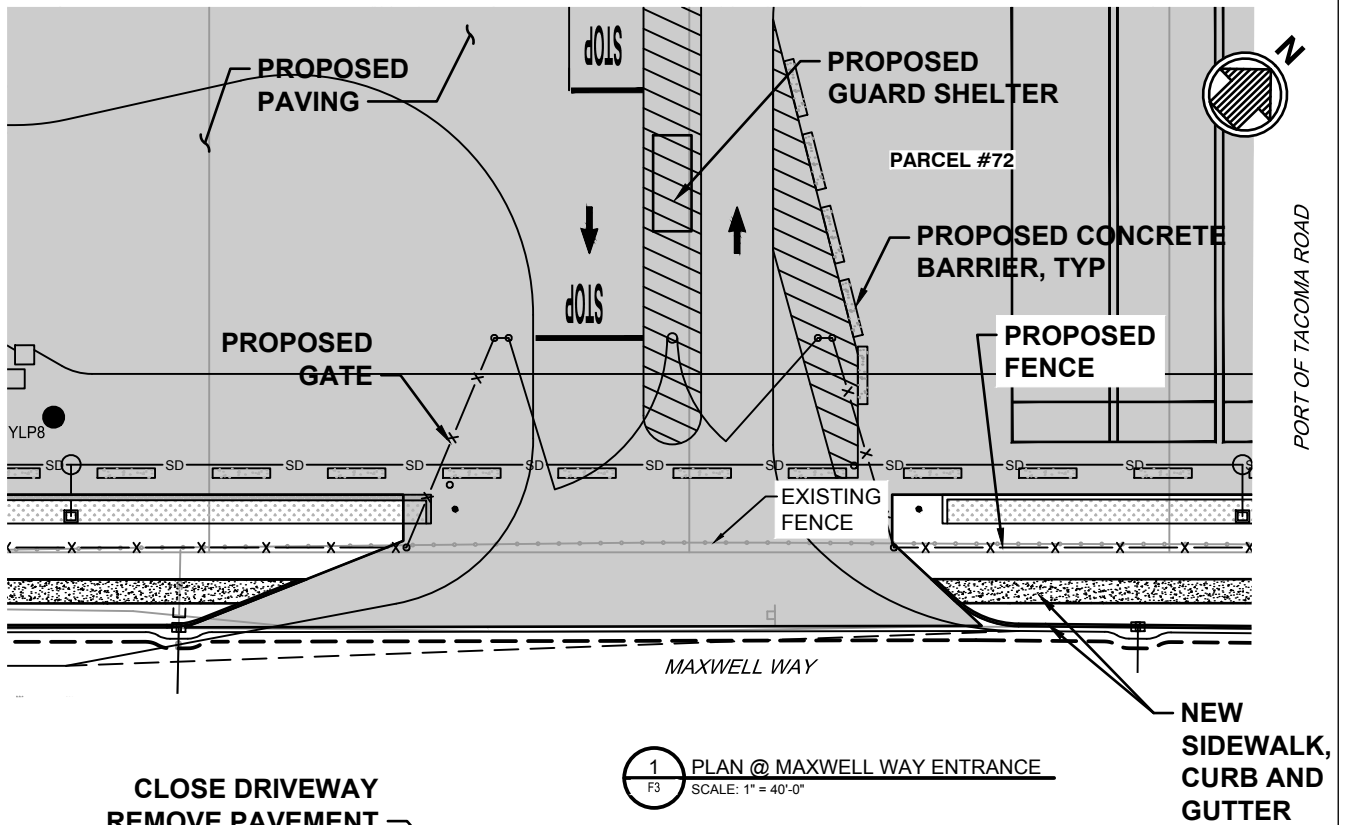

USACE REFERENCE: NWS-2020-557-WRD

APPLICANT: PORT OF TACOMA

ADJACENT PROPERTY OWNERS:
SEE THE JOINT AQUATIC RESOURCES
PERMIT APPLICATION (JARPA)

LOCATION: 1451 & 1721 THORNE ROAD AND
1702 PORT OF TACOMA ROAD
TACOMA, WA
LAT/LONG: 47.264 N
-122.401 W
DATUM: MLLW=19.39' TIDE 22 1935 BENCHMARK
SHEET: 6 OF 7 DATE: OCTOBER 22, 2022

PROPOSED PROJECT: OFF-DOCK CONTAINER
SUPPORT FACILITY

IN: NOT LOCATED IN A WATERBODY
NEAR/AT: CITY OF TACOMA
COUNTY: PIERCE STATE: WA
SEC: 34 T: 21 N R: 3 E

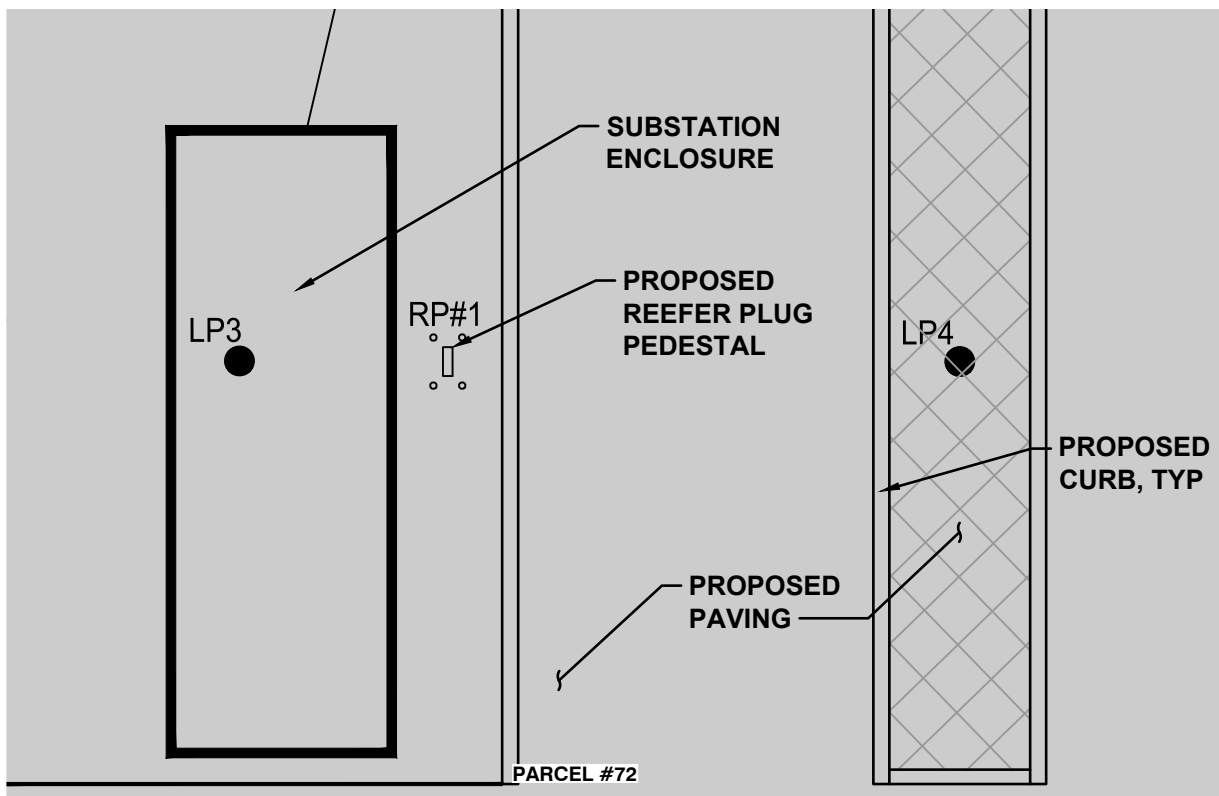

1 PLAN AT ELECTRICAL SUBSTATION AREA
F3 SCALE: 1"=20'

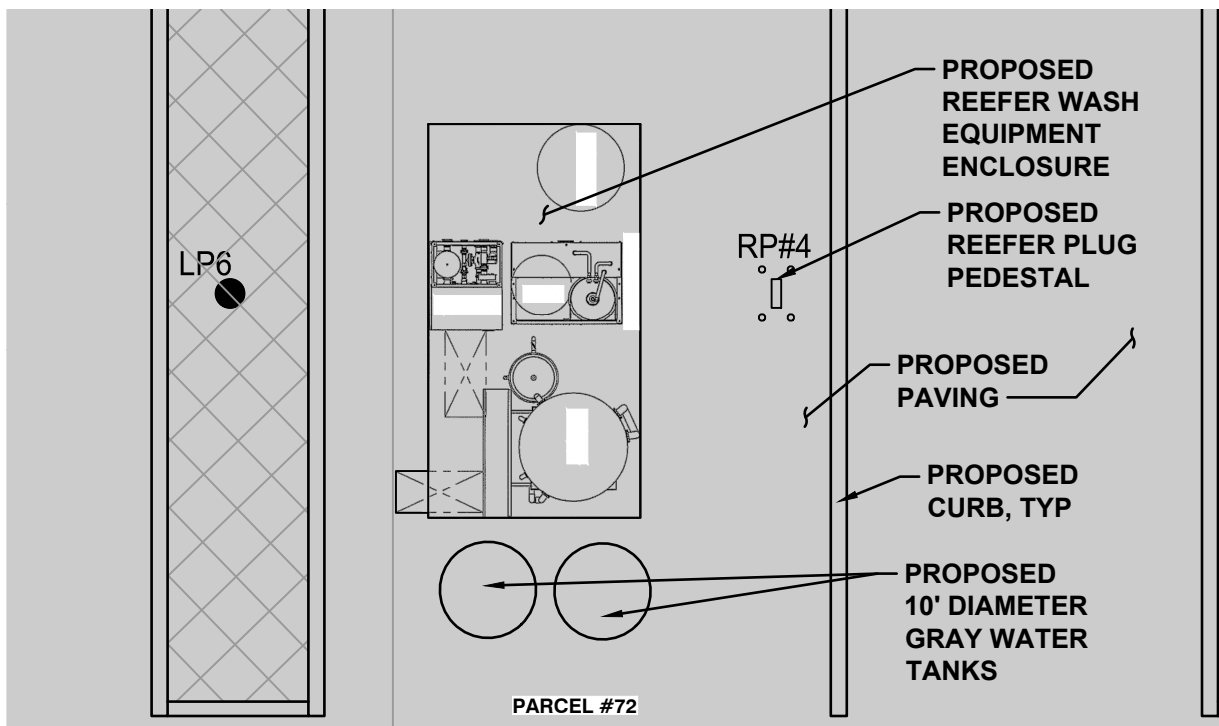

20' 0' 20' 40'
SCALE: 1"=20'

2 PLAN AT WASH ENCLOSURE
F3 SCALE: 1"=20'

USACE REFERENCE: NWS-2020-557-WRD APPLICANT: PORT OF TACOMA ADJACENT PROPERTY OWNERS: SEE THE JOINT AQUATIC RESOURCES PERMIT APPLICATION (JARPA)	LOCATION: 1451 & 1721 THORNE ROAD AND 1702 PORT OF TACOMA ROAD TACOMA, WA LAT/LONG: 47.264 N -122.401 W DATUM: MLLW=19.39' TIDE 22 1935 BENCHMARK SHEET: 7 OF 7 DATE: OCTOBER 22, 2022	PROPOSED PROJECT: OFF-DOCK CONTAINER SUPPORT FACILITY IN: NOT LOCATED IN A WATERBODY NEAR/AT: CITY OF TACOMA COUNTY: PIERCE STATE: WA SEC: 34 T: 21 N R: 3 E
---	---	---